



www.mysnowsport.com

If you find a part, or parts missing or defective, or if you're having trouble installing your new plow, please have serial number ready (found on decal on back of blade) and call the customer service number 701-251-1427. **It is recommended that you take the time to review all the material in this manual, even if already familiar with the product, because often changes are made without prior notice.**

ATTENTION OWNERS AND OPERATORS:
SAVE THIS INSTALLATION/OPERATORS MANUAL. READ AND FOLLOW THE OPERATING AND SNOW PLOWING PRACTICES. PLEASE HAVE SERIAL NUMBER AVAILABLE (FOUND ON DECAL ON BLADE) IF CALLING FOR CUSTOMER SERVICE ASSISTANT.

IMPORTANT

Promptly confirm your warranty registration on-line at www.agricover.com.

FOR YOUR RECORDS:

DATE PURCHASED _____

WHERE PURCHASED _____

SERIAL NUMBER _____

(Located on decal on back of blade)

BASIC SNOWPLOWING PRACTICES

The SNOWSPORT utility plow was designed to make moving snow convenient and easy, and by following some simple tips, snow removal can be a safe, enjoyable experience. *Always keep current with the snowfall. It's easier to plow fresh snow. Wet snow can compact and freeze which requires chipping to break it loose before attempting to move it.* From the start of the season push the snow far enough out to allow for future snowfalls. Avoid overloading your equipment - push only enough snow with each pass to get the job done. To start a pass, accelerate slowly - allowing for tire traction and blade to accumulate snow. As you come to the end of a pass, lift off the accelerator and start applying brakes as needed. If snow is deep and/or compacted you may need to go over it two or three times.

- When pushing snow up to hardened snow piles – **DO SO STRAIGHT-ON – NOT AT AN ANGLE.**
- Always know the terrain before plowing
- When transporting blade, secure it to retainer brackets with snap pins
- Do not exceed 65 MPH when transporting plow
- Do not exceed 10 MPH when plowing
- Always wear your seat belt when plowing
- Never plow with your head out of the window – an unexpected sudden stop could result in personal injury
- When backing up don't rely on rear view mirrors – turn around and look where you are going
- Never pile snow on someone else's property, on street or sidewalks, by fire hydrants, mailboxes, water drains or electrical boxes
- Check with local regulations before pushing snow across roads – it may be illegal
- Do not pile snow near handicapped or parking areas
- Plow snow during low-traffic hours – be cautious of pedestrians, domestic animals and vehicles
- Never pile snow where it obstructs visibility of traffic
- Remember – always exercise safety, courtesy, and common sense
- On 4WD select low range
- On manual transmission - avoid riding clutch
- Watch engine heat gauge and avoid overheating
- Follow vehicle manufacturers specifications for snowplowing

MANUFACTURER'S LIMITED WARRANTY

Agri-Cover, Inc. extends the following limited warranty on its SNOWSPORT Utility Plow to the original retail purchaser of any SNOWSPORT Utility Plows purchased after October 1, 2007:

Agri-Cover, Inc. warrants its SNOWSPORT Utility Plow to be free from defects in material and workmanship under normal use for three (3) years from date of purchase.

ANY IMPLIED WARRANTY APPLICABLE TO THE SNOWSPORT UTILITY PLOW IS LIMITED IN DURATION TO THREE YEARS FROM THE DATE OF PURCHASE. Agri-Cover's sole obligation under this warranty or any implied warranty is limited to the repair or replacement at its option, of defective parts only. No labor or service allowance is given or implied. **IN NO EVENT SHALL AGRI-COVER, INC. BE LIABLE FOR INCIDENTAL, CONSEQUENTIAL, OR SPECIAL DAMAGES.** Some states do not allow limitations on how long an implied warranty lasts or exclusions of incidental or consequential damages, so the above limitations and exclusions may not apply to you.

For warranty performance call our Customer Service Department at 701-251-1427 to determine if only a replacement part is needed or if the product needs to be returned for inspection and repair. **Warranty registration must be on file and/or proof of original purchase (detailed and dated receipt) required for warranty to be effective. Goods to be returned must have a pre-authorized FA # (Returned Authorization Number) – obtained by calling the number above.** Mark the number on the package and ship it freight prepaid to address below. Agri-Cover will pay freight to return goods to sender.

This limited warranty does not cover any failure due to abuse, misuse, alteration, neglect, improper assembly or installation, or improper maintenance.

This limited warranty gives you specific legal rights and you may have other rights which vary from state to state.



Agri-Cover, Inc.
Customer Service Dept.
3000 Hwy. 281 SE, PO Box 508
Jamestown, ND 58402
Phone (701) 251-1427

Parts Diagram

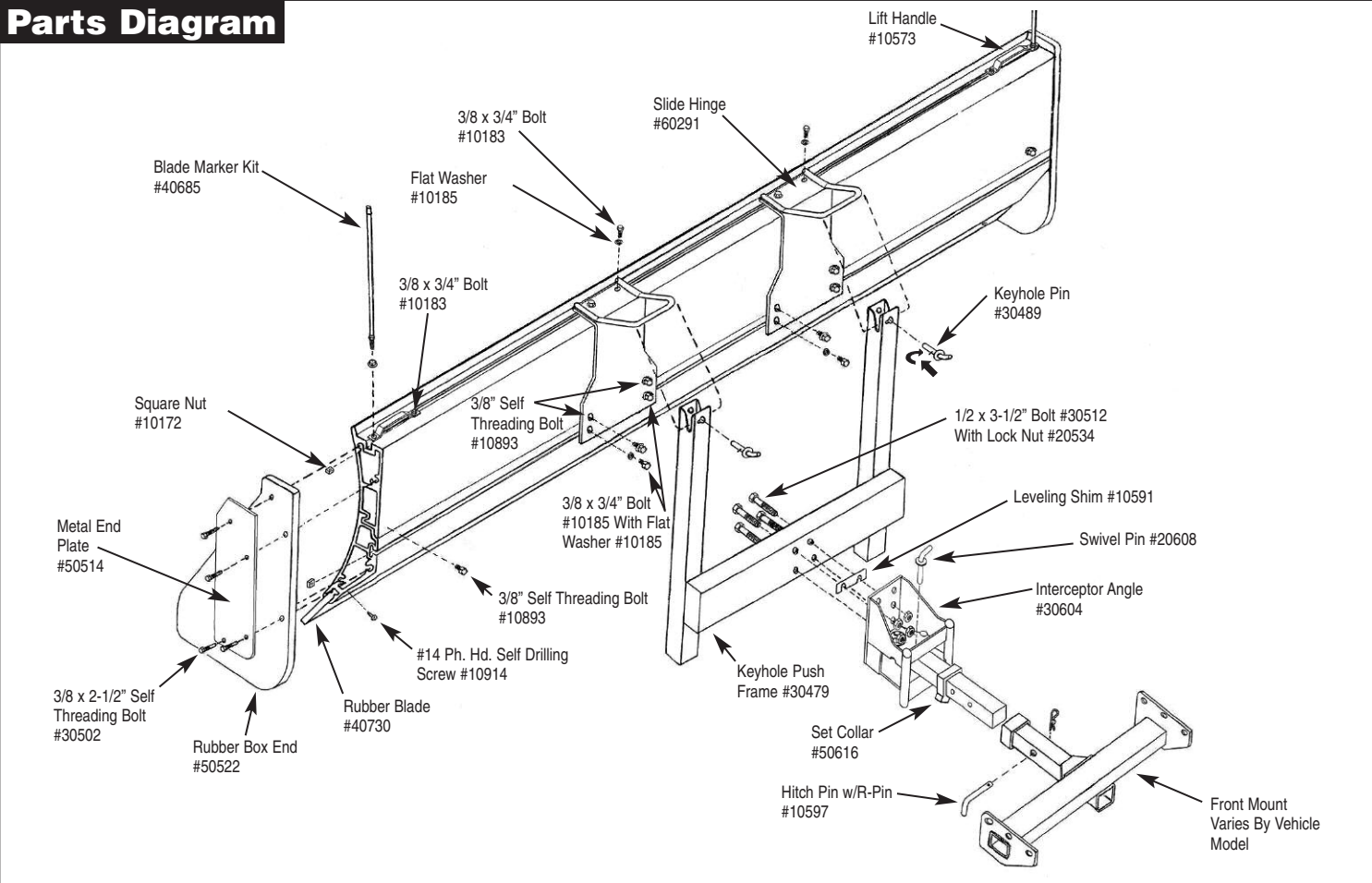

NOTE: Prior to plow assembly, park vehicle on level grade and install plow mount receiver (instructions with receiver). Clearance under receiver should measure between 8 to 16 inches above grade.

Tools Needed (plow assembly):

Ft./lb. torque wrench
Impact or ratchet with 9/16 and 3/4 socket
Drill with 3/16 and 5/16 drill bit

#3 Phillips driver bit
Box wrench 3/4
Open wrench 5/16
Allen wrench 3/16

2 short pcs. of 2 x 4 blocking
Bubble level
Protective eyewear

1 INTERCEPTOR CAN BE INSTALLED WITH LEG TURNED UP OR DOWN AS NEEDED FOR PROPER PUSH FRAME CLEARANCE (SHOWN TURNED UP IN ILLUSTRATIONS).

a) Insert interceptor into receiver - leg up. Secure with pins (interceptor has choice of holes to allow for clearance when angling blade). Hold push frame against interceptor. Select 4 bolt hole pattern that positions **push frame 8" - 10" above grade**. If lowest bolt pattern is too high, remove interceptor and turn leg down. Bolt push frame (4 bolts 1/2 X 3-1/2 w/lock nuts) to proper hole height on interceptor - **leave bolts snug tight for now**.

b) Push set collar tight against receiver - hold and tighten set screw with 3/16 allen wrench.

2

a) With bolts snug tight, level push frame horizontally.

b) Check push frame for vertical plumb. If plumb, tighten 4 bolts now and go to step 3. If not plumb - refer to shim procedure at right.

c) If push frame leans towards front of vehicle, shim at top pair of bolts. If push frame leans away from front of vehicle, shim from front of vehicle, shim at bottom pair of bolts. **WHEN SHIMMING IS COMPLETE - TIGHTEN ALL 4 BOLTS.**

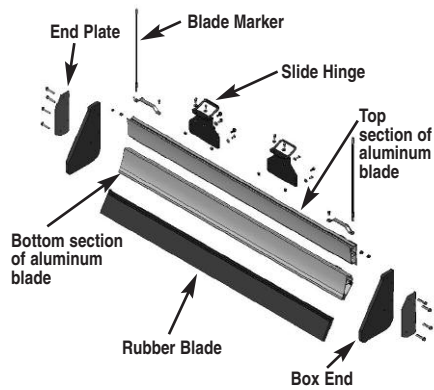
3

a) Illustration above shows exploded view components for plow blade parts.



b) Align end of rubber edge with matching channel in bottom section of aluminum blade and slide in until flush at both ends.

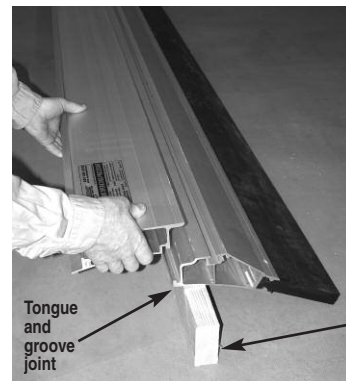

c) Turn bottom half of blade over and set it on wood blocks, one at each end as shown. Take top half and connect tongue and groove joint with bottom half. Slide sections until flush at both ends.

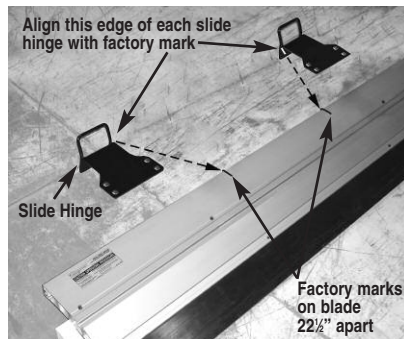
4

a) Place each slide hinge on blade and align edge of hinge with factory mark on blade.



b) When both hinges are properly aligned - they should measure 22-1/2 inches apart.

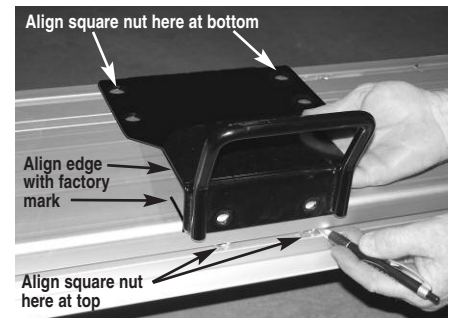

c) At end of blade, insert two square nuts in each channel - flat side facing out. Slide nuts over to hinge and align them with holes at top and bottom.

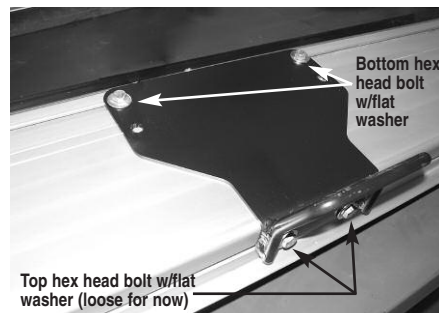
5

a) Turn 3/8 x 3/4" hex bolts with flat washer into nuts on top section of blade **and leave loose**. Turn 3/8 x 3/4" hex bolts into nuts on bottom section of blade **and leave loose**.

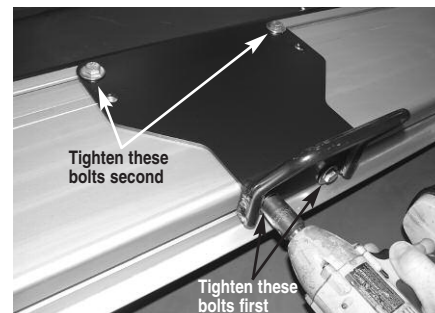

b) Make sure slide hinge is lined up with mark (see Step 3). Using 9/16" wrench, **tighten hex bolts in top section first**. Then tighten hex bolts on bottom section.

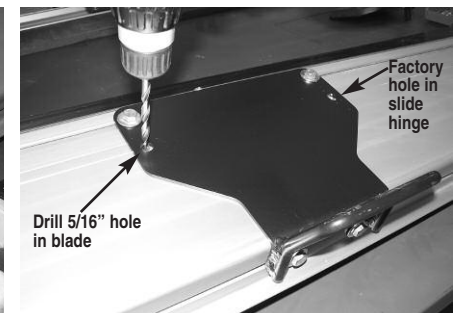

c) Using 5/16" bit, drill a hole through blade in each factory punched hole on slide hinge. Turn a (short) 3/8" self threading bolt into each drilled out hole and tighten. Repeat steps to attach opposite slide hinge.

6

a) At tongue-n-groove joint, drill a 5/16" pilot hole at factory mark (1 at each end).

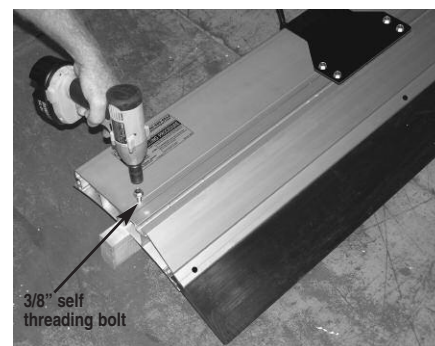

b) Using a 9/16" wrench turn a (short) 3/8" self threading bolt into 5/16" pilot hole and tighten. Repeat at other end.

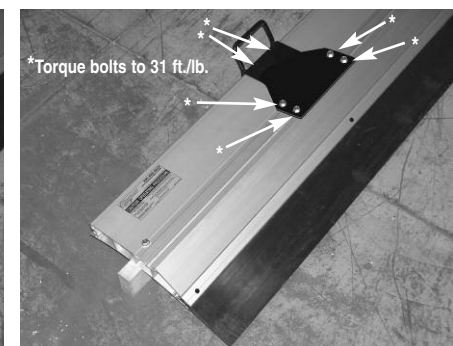

c) Using torque wrench, tighten all (6) bolts on each slide hinge to 31 ft./lbs.

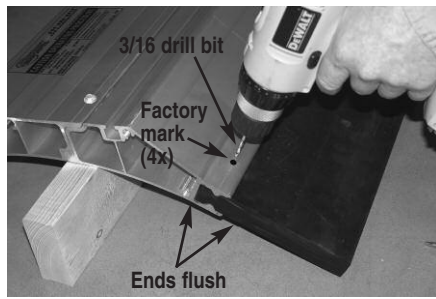
7

a) At bottom of blade (where rubber is inserted, check to make sure ends are flush), then drill a 3/16 inch pilot hole at factory mark in v-groove (4 locations) – drill only through 1st layer of aluminum and into rubber. Repeat this drilling procedure for three remaining marks.

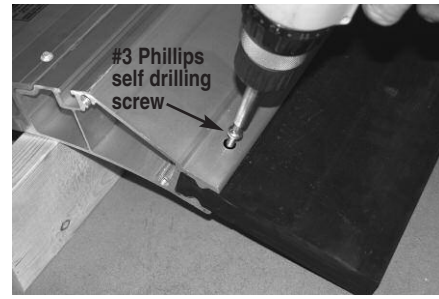

b) Using Phillips #3 bit, run a self drilling screw into each of the four pilot holes. This prevents rubber from movement.

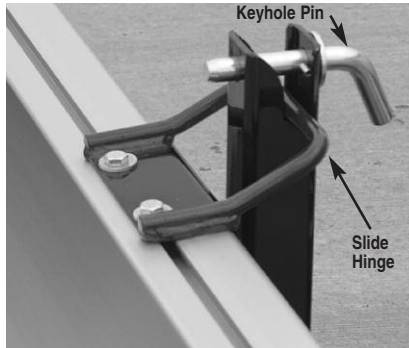
8

a) Hang blade on push frame in the transport position and insert key hole pins.

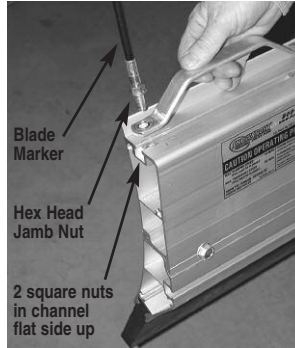

b) Insert two square nuts into top channel. Turn a hex nut onto stud of blade marker and align marker with hole on lift handle and bolt marker and handle to blade using square nut in channel.

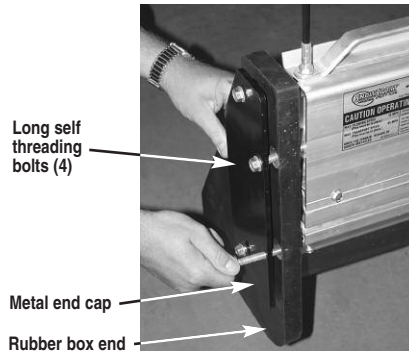

c) Turn 3/8 x 3/4 bolt into other hole on handle and thread to nut in channel. Handle should be flush with blade edge. Then tighten both bolts on lift handle. Repeat at other end.

9

a) Attach rubber end and metal cap plate to end of blade with four long self threading bolts.



b) Tighten all bolts until rubber begins to compress to blade.



c) Tighten all bolts equally. Repeat box end assembly at opposite end.

OPERATION INSTRUCTIONS

1. TO LOWER FOR PUSHING SNOW:

Step behind blade and remove keyhole pin. Lift one side of blade out of retainer until slide hinge fits over the push bar, then lower blade to ground. Re-insert keyhole pin. Repeat same procedure for other side of blade.

2. TO PUSH SNOW:

Drive forward slowly - blade will engage for pushing. When push is finished, backing up disengages the blade until you are realigned for next push. Repeat this procedure until job is finished.

3. TO STORE BLADE FOR TRANSPORTING:

Reverse procedure from step 1 and re-insert keyhole pins.

4. TO STORE BLADE DURING OFF SEASON:

For maximum blade life, periodically retighten bolts and protect blade from sun by storing it inside or covering.

OPERATORS NOTE: WHEN PUSHING SNOW ONTO A PILE, ALWAYS DO SO WITH BLADE IN THE STRAIGHT FORWARD POSITION. PILING SNOW WITH BLADE ANGLED MAY CAUSE DAMAGE TO PLOW OR VEHICLE COMPONENTS.

ANGLED INTERCEPTOR NOTE: THERE ARE TWO HOLES IN THE INTERCEPTOR SHAFT. WHEN INSERTING ANGLE INTERCEPTOR INTO FRONT MOUNT RECEIVER, SELECT THE HOLE WHICH ALLOWS BLADE TO SWING ITS FULL ANGLE WITHOUT CONTACTING VEHICLE.

